

Note that all unique customer requirements (i.e tolerance) need to be verified thru Alfa Laval.

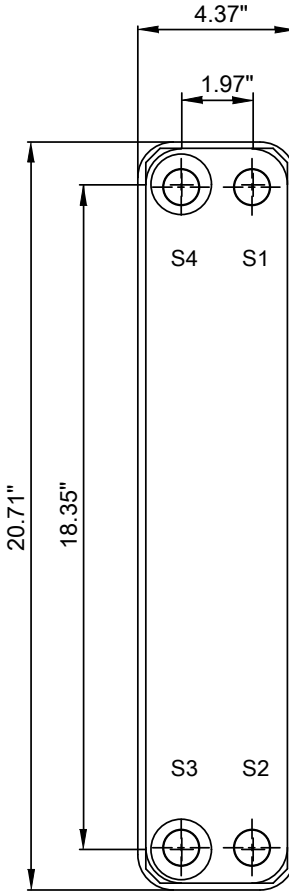
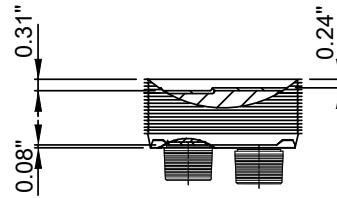
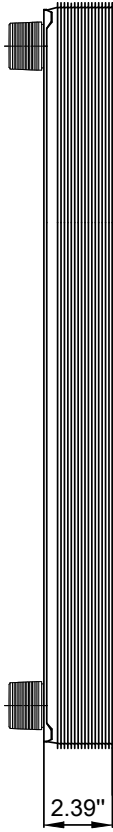
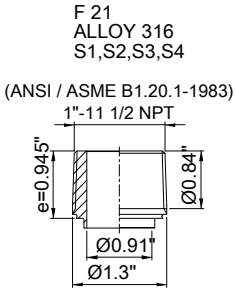

Frameplate is depressed 0.08 inches at connection S3/S4
 Pressureplate is depressed 0.08 inches / even number of channel plates
 at connections T3/T4 / uneven number of channel plates at
 connections T1/T2.

HEATING SURFACE ft²
 NETWEIGHT 14.3 lb
 OPERATING WEIGHT lb
 PLATE MATERIAL ALLOY 316
 PLATE GROUPING 1*9H/1*10H

T1 T2 T3 T4 locations on back side
 correspond to S1 S2 S3 S4 on front side

ALL DIMENSIONS IN INCHES

| SIDE | MEDIA | INLET | TEMP. | OUTLET | TEMP. | FLOW RATE | PRESSURE DROP | LIQUID VOL. |
|------|-------|-------|-------|--------|-------|-----------|---------------|----------------------|
| 1 | Water | S1 | °F | S2 | °F | lb/h | psi | 0.03 ft ³ |
| 2 | Water | S3 | °F | S4 | °F | lb/h | psi | 0.03 ft ³ |

PRESSURE VESSEL APPROVAL

PED/CRN



AlfaNova 52-20H (3287000896)

www.alfalaval.com

CUSTOMER NAME / REF. NO.

COMPANY / REF.
 Alfa Laval Nordic AB
 Alfa Laval Inc.

TOTAL LENGTH 3.3 in
 TOTAL WIDTH 4.4 in
 TOTAL HEIGHT 20.7 in

8/25/2021
 REV 0